

Ambient Air Temperature Sensor

Removal

NOTE: Removal steps in this procedure may contain installation details.

1.
 - Using a suitable tool, pry and detach the ambient air temperature sensor bezel from the LH exterior mirror housing.
Use the General Equipment: Flat-Bladed Screwdriver
 - Disconnect the ambient air temperature sensor electrical connector and remove the ambient air temperature sensor.

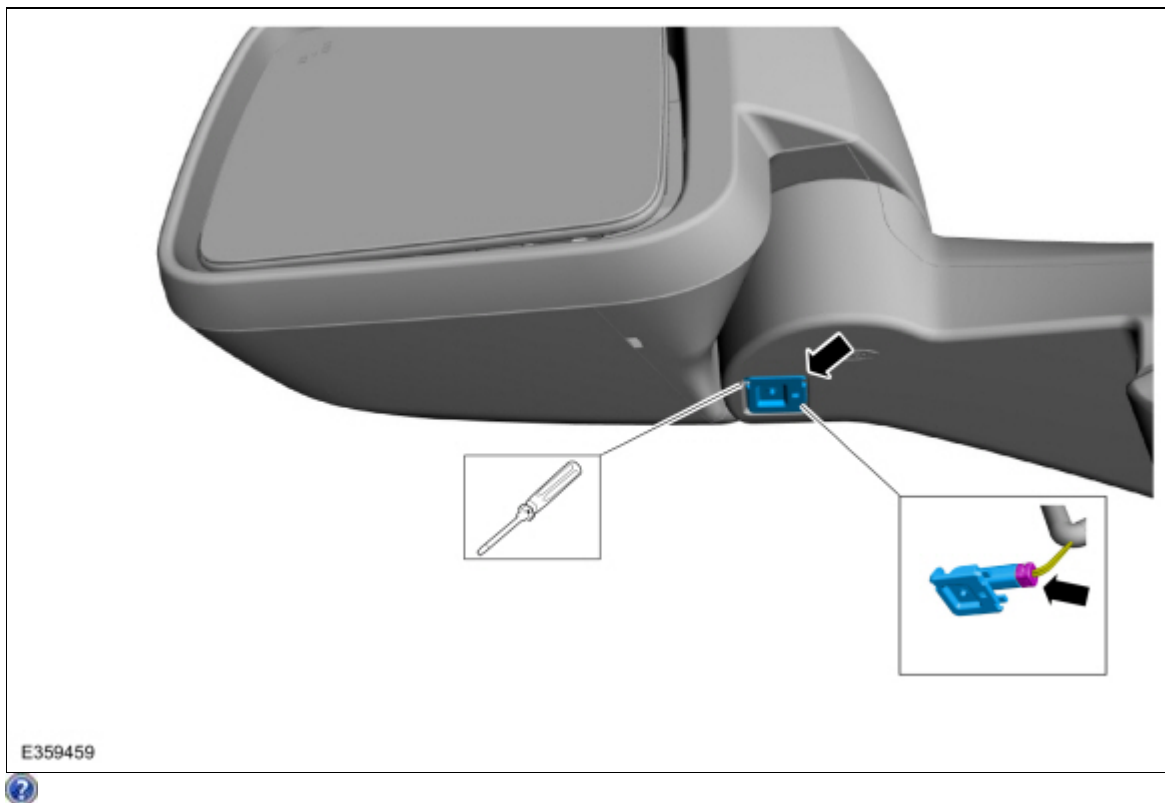

Installation

1. To install, reverse the removal procedure.
 - If replacing the ambient air temperature sensor a reset must be performed.
Refer to: [Reset the Outside Air Temperature Sensor Learned Values](#) (412-00 Climate Control System - General Information, General Procedures).